

| REVISIONS | | |
|-----------|-------------|------|
| REV. NO. | DESCRIPTION | DATE |
| | | |

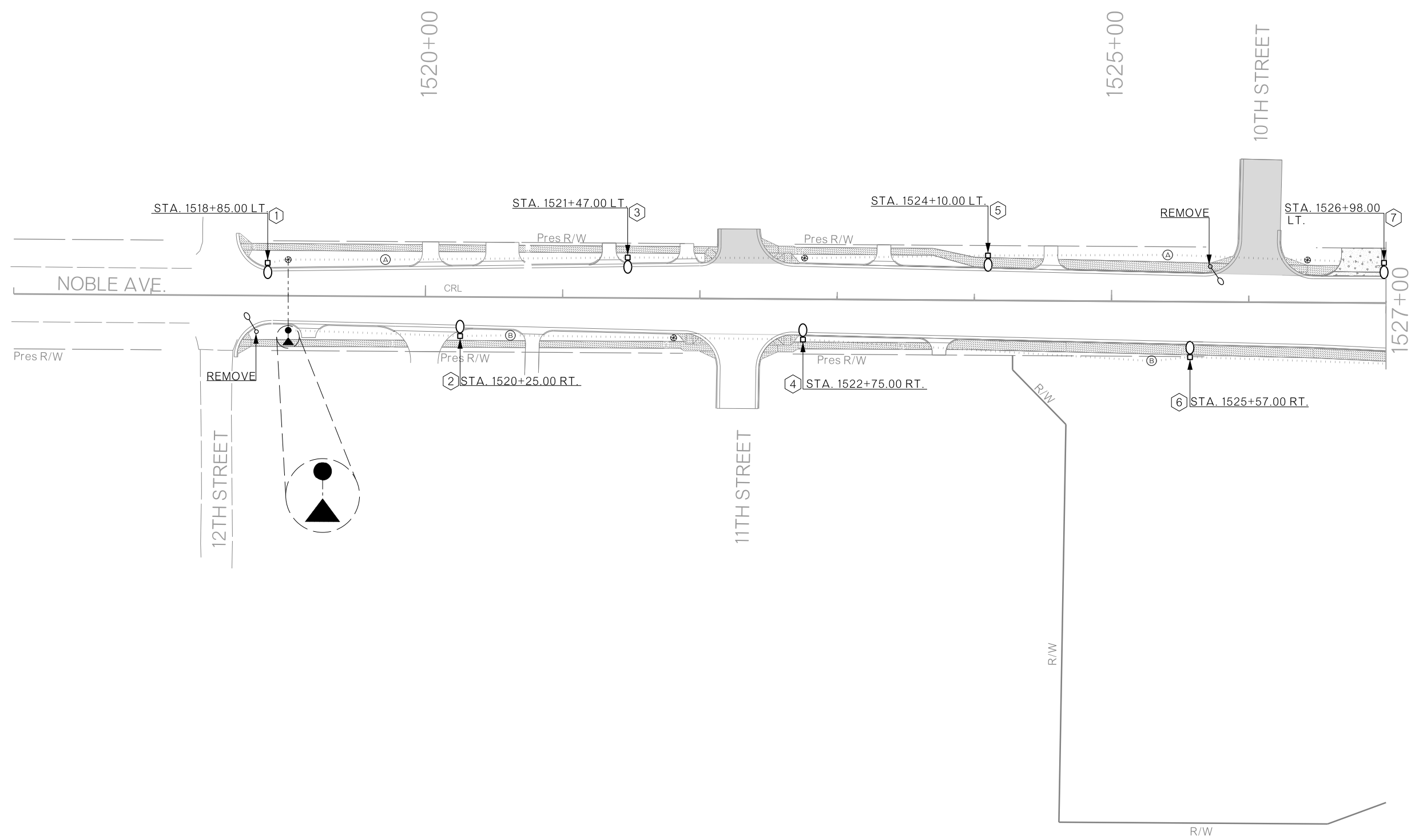

LIGHTING LEGEND

- ⊕ SIZE I PULL BOX
- SIZE II PULL BOX
- 400W LED LUMINAIRE, 40' MTG. HT. POLE NON-BREAKAWAY BASE AND FOOTING
- ⊖ 400W LED LUMINAIRE, 40' MTG. HT. POLE BREAKAWAY BASE AND FOOTING
- ▲ NEW SERVICE POLE
- Ⓐ CIRCUIT IDENTIFICATION
- 1-1/4" GALV. STL. ELECT. CONDUIT EXPOSED WITH TWO NO. 4 AWG CONDUCTORS (UNLESS OTHERWISE SPECIFIED)
- 2" PVC ELECT. CONDUIT TRENCHED WITH TWO NO. 4 AWG CONDUCTORS (UNLESS OTHERWISE SPECIFIED)
- - - 2" ELECT. CONDUIT PUSHED OR BORED WITH TWO NO. 4 AWG CONDUCTORS (UNLESS OTHERWISE SPECIFIED)
- LIGHT POLE

| | | | |
|----------------------|--------------------------------------|-----|------|
| LIGHTING PLAN | Drawn | JF | 3/16 |
| | Design | JF | 3/16 |
| | Checked | KCD | 7/16 |
| | TRAFFIC ENGINEERING TAREK MAAROUF | | |

| | | | |
|-------------------|------------|-------------------------|----------------|
| STATE OF OKLAHOMA | DIVISION 4 | JOB/PIECE NO. 21860(04) | SHEET NO. T012 |
|-------------------|------------|-------------------------|----------------|